

SNAPCOM



MMS Advanced GSM Intercom

Sends out a snapshot of the caller straight to your mobile before you answer.

- Works with a contract GSM Nano SIM card with MMS plan (recommended) or a Pre-Pay SIM card.
- Comes with optional contract SIM, unlimited calls and texts (UK/IRE only) (Please check out www.aesglobaltelecom.com for sim card information)
- **NEW** AES Pro app for installer programming (December release).
- Home owner option on app: able to trigger gates, set up auto opening and closing times, create new access codes, receive notifications on entry, etc.



SNAPCOM



Set automatic gate open & close times.



DDA LEDs. (Call/ relay status indicators).



Illuminated call button and keypad.



Add keypad codes by App*.



Issue time restricted codes.



Visitor snapshot sent to mobile by MMS messaging.



LED strip lighting for high quality MMS snapshot.



User history log to your phone.



High gain antenna as standard!



2x Relays

Technical Details

Dial Out Numbers	4	Relays	2
Permanent Codes	250	Relay Type	N/C and N/O
Time Restricted Codes	250	Relay Load	2 amps, 24v ac max
Temporary Codes	50	Power Consumption	400mA on dial out, 2amp peak demand
Automatic Trigger Events per Week	50	Modem Models	4G Europe, 4G USA, 4G AUS/NZ
Caller ID Numbers	250	Power Supply	24v dc (24v dc 2A adaptor included)
Time Restricted Caller ID Numbers	250		

*New user friendly new app for both installers and homeowners. Coming in December 2021. It will be available on both iPhone and android devices.



Architectural Panels

Network code for part number.

4GE (Europe)

4GA (USA)

4GAU (Australia & NZ)

SNAPCOM-AB/XX

Stylish curved architectural model. Constructed from BS316 marine grade stainless steel and finished with gloss black acrylic trim. Modern blue backlighting.

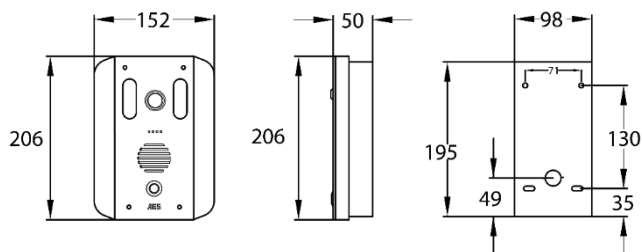

SNAPCOM-ABK/XX

Stylish curved architectural model.

Constructed from BS316 marine grade stainless steel and finished with gloss black acrylic trim. Modern blue backlighting with integrated keypad.

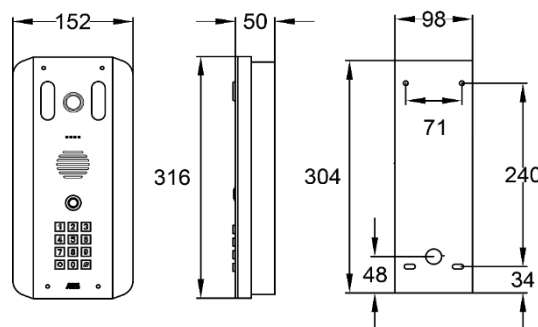

Flush Panels

SNAPCOM-FB/XX

Sleek flush model.

Constructed from BS316 marine grade stainless steel and finished with gloss black acrylic trim.

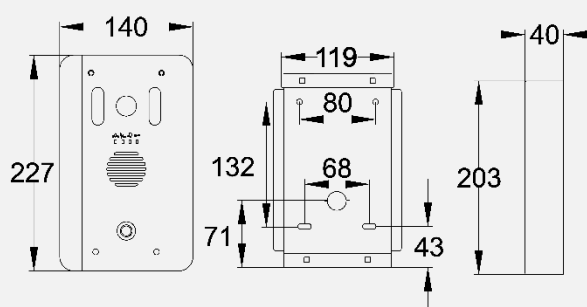

SNAPCOM-FBK/XX

Sleek flush model with keypad.

Constructed from BS316 marine grade stainless steel and finished with gloss black acrylic trim.

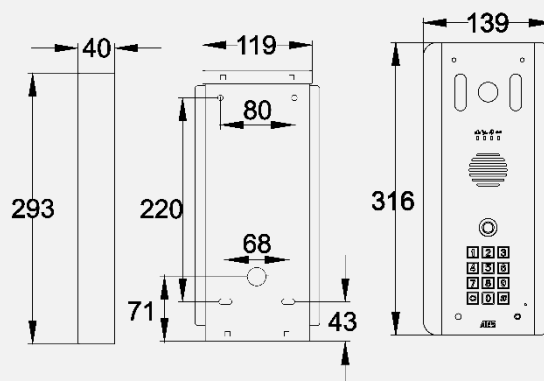



Imperial Panels

Network code for part number.

4GE (Europe)

4GA (USA)

4GAU (Australia & NZ)

SNAPCOM-IMP/XX

Sleek all black imperial model. Constructed from BS316 marine grade stainless steel and finished with gloss black acrylic trim. Blue luminated button.

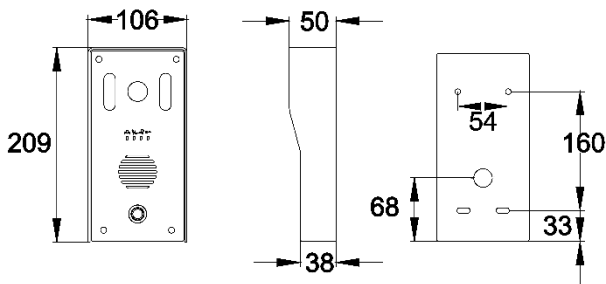

SNAPCOM-IMPK/XX

Sleek all black imperial model with keypad.

Constructed from BS316 marine grade stainless steel and finished with gloss black acrylic trim. Blue luminated keypad.

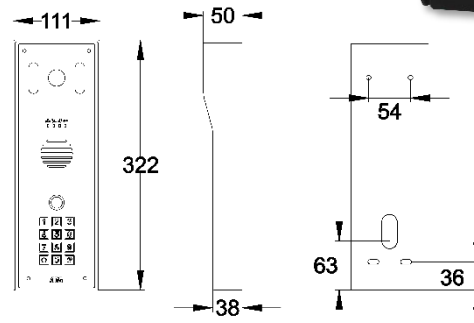

Industrial Pedestal Panels

SNAPCOM-PED/XX



Industrial pedestal model. Constructed from BS316 marine grade stainless steel and finished with gloss black acrylic trim. Blue luminated button.

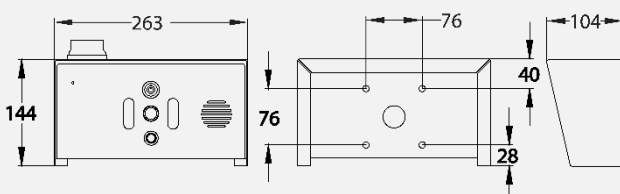

SNAPCOM-PED-KP/XX



Industrial pedestal model with Keypad.

Constructed from BS316 marine grade stainless steel and finished with gloss black acrylic trim. Blue luminated keypad.

